

# Nohea

AT MAUNA LANI

Luxury Resort Residence

4 Beds | 4 Baths | 2,795 sq ft

\$2,900,000

## Lot 25

TROPICAL-INSPIRED, BALI ARCHITECTURE  
FEATURING "POD" STYLE LIVING SPACES

Lot 25 is a newly constructed, luxury estate which features a Balinese, tropical inspired design with majestic views of the Kohala Mountains and beyond. Enjoy premier privacy, high-end fixtures and finishes including Sub Zero and Wolf appliances. Individually designed fret-work moldings accentuate the soaring ceilings and await your inspection. Owners enjoy exclusive access to Nohea's Amenity Center that includes an owner's Hale featuring a full kitchen and plenty of room for gatherings of friends and family. Enjoy the fitness Hale with expertly specified Life Fitness equipment and the 2-BBQ pavilions ready for your next special occasion.

Quality hardware accentuate the rich, hardwood trims, doors and cabinetry. Large sliding doors open the views of the private pool, spa and rear courtyard. Enjoy the chef's kitchen with a Wolfe 6-burner gas range, Sub Zero refrigeration, luxurious cabinetry and Quartz counter tops. Multi-zone air conditioning offer energy savings and individual room temperature control.

Enjoy the hardwood floors in the living areas and porcelain tile throughout the bathrooms and laundry room. The 4th Bedroom features a built in, ZOOM ROOM bed that automatically extends from the built in cabinets and retracts to allow instant conversion to a media room or office. The free-form pool and spa are heated and the rear yard offers plenty of area for large gatherings. Nohea offers right sized home sites with views to golf fairways and the majestic Mauna Kea, Hualalai and Kohala Mountains and beyond—all cooled by pacific breezes and lulled by sounds of the ocean not far away.



▶ THE ENTRANCE PORTAL LEADS TO A LUSH, TROPICAL GARDEN COURTYARD. THE GARAGE FEATURES A DOOR THAT EMPHASIZES THE HOME'S UPCOUNTRY ESTHETIC.

▶ ALL BEDROOMS OPEN TO VIEWS OF INTERIOR COURTYARD LANDSCAPING OR THE POOL/SPA FEATURE.

▶ THE REAR LANAI OVERLOOKS THE LAGOON STYLE POOL AND LARGE SPA AND FEATURES PAVILION SIZED SHADE STRUCTURES FOR MAXIMUM COMFORT ON SUNNY DAYS.

▶ CUSTOM DESIGNED FRETWORK PANELS ACCENTS THE GREAT ROOM AND MASTER BEDROOM CEILINGS.

▶ THE MASTER BATHROOM'S OUTDOOR SHOWER ALLOWS PRIVATE ACCESS TO THE POOL AND SPA.

▶ THE CHEF'S KITCHEN INCLUDES A WOLF, 6-BURNER, GAS RANGE, SUB ZERO REFRIGERATION, AND LUXURIOUS CABINETRY WITH QUARTZ COUNTER TOPS.



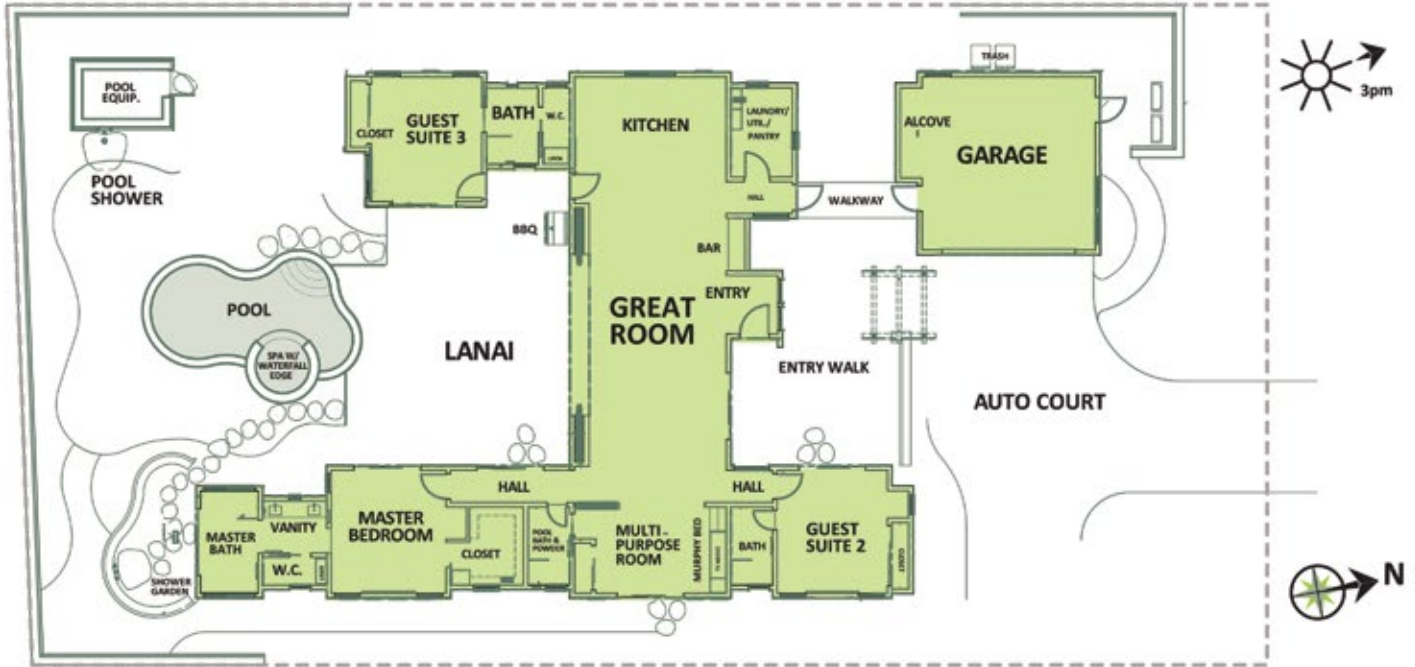

Lot Size: *approximately 12,097 ft<sup>2</sup>*    Enclosed Living Area: 2,795 ft<sup>2</sup>    Bedrooms: 4  
 Garage: 519 ft<sup>2</sup>    Bathrooms: 4



Follow, Like, Visit



NoheaatMaunaLani.com